



Kellyville



Auction

On Site Saturday 27th June at 2:00 pm

Perfect In-Law Accommodation Or Investment Opportunity

Unit 2/60 Hezlett Road

This versatile apartment offers a unique opportunity for buyers as either the perfect in-law accommodation or a stepping stone to invest in the hugely popular Kellyville precinct. This brand new 1 bedroom apartment sits on the high side of this estate on a corner block. The apartment has a separate entry via the private yard which is fully fenced and easily accessible via the front gate.

As you proceed upstairs, you will be impressed with the quality finish and natural light captured in the bright kitchen and living area. The kitchen is equipped with a walk-in pantry, stone benchtops and quality Westinghouse stainless steel appliances. This area flows out onto a large balcony with views across the estate. The bedroom features a triple built-in wardrobe and has a modern ensuite equipped with a HPM light/heater.

The apartment has a single car garage with remote controlled access, internal laundry facilities and additional under stair storage. With quality extras like an intercom, Ness alarm system, downlights in living areas and an Actron split system air conditioner this apartment is sure to please.

For a truly unique property opportunity call us to inspect or come along to the open homes. This strata titled apartment will be auctioned on site Saturday June 27th at 2 pm unless sold prior.

ZARZAR
REAL ESTATE

8882 9980

Contact John Cappello 0417 330 663
Lyn Batson 0428 855 893

www.zarzar.com.au

All information contained herein is gathered from sources we believe to be reliable. However, we cannot guarantee its accuracy, and interested parties should rely on their own enquiries

Unit 2/60 Hezlett Road, Kellyville

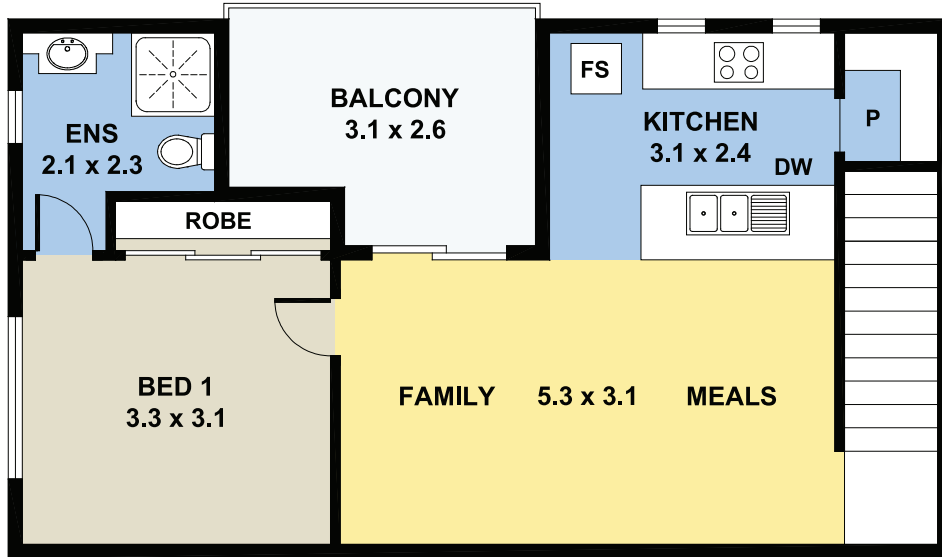

FIRST FLOOR

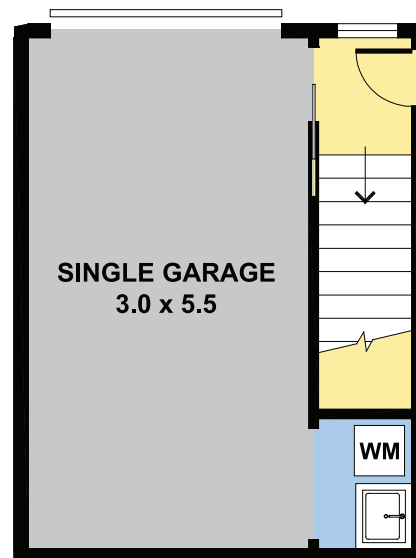

GROUND FLOOR

Please note: All stated dimensions are approximate only. Particulars given are for general information only and do not constitute any representation on the part of the vendor or agent.